



### SPECIFICATIONS

**CONTACT RATING:** AC 125V 6A, AC 250V 3A ,DC 30V 3A

**MECHANICAL LIFE:** 100,000 make-and-break cycles  
DC 10V & 0.1mA.

**CONTACT RESISTANCE:** 10 mΩ max.

**INSULATION RESISTANCE:** 500V 500 MΩ min.

**DIELECTRIC STRENGTH:** 1,000 Vrms min. @sea level.

**OPERATING TEMPERATURE:** -30°C to 85°C.

**WATER-RESISTANCE:** 100 make-and-break cycles min at 10 cm depth for T12 actuator.

### MATERIALS

**CASE:** Diallyl phthalate (DAP) (UL94v-0).

**ACTUATOR:** Brass,chrome plated.

**BUSHING:** Brass,nickel plated.

**HOUSING:** Stainless Steel.

**SWITCH SUPPORT:** Brass,tin plated.



**TERMINAL/CONTACT:** Brass,with silver or gold plated.(See Page 22)

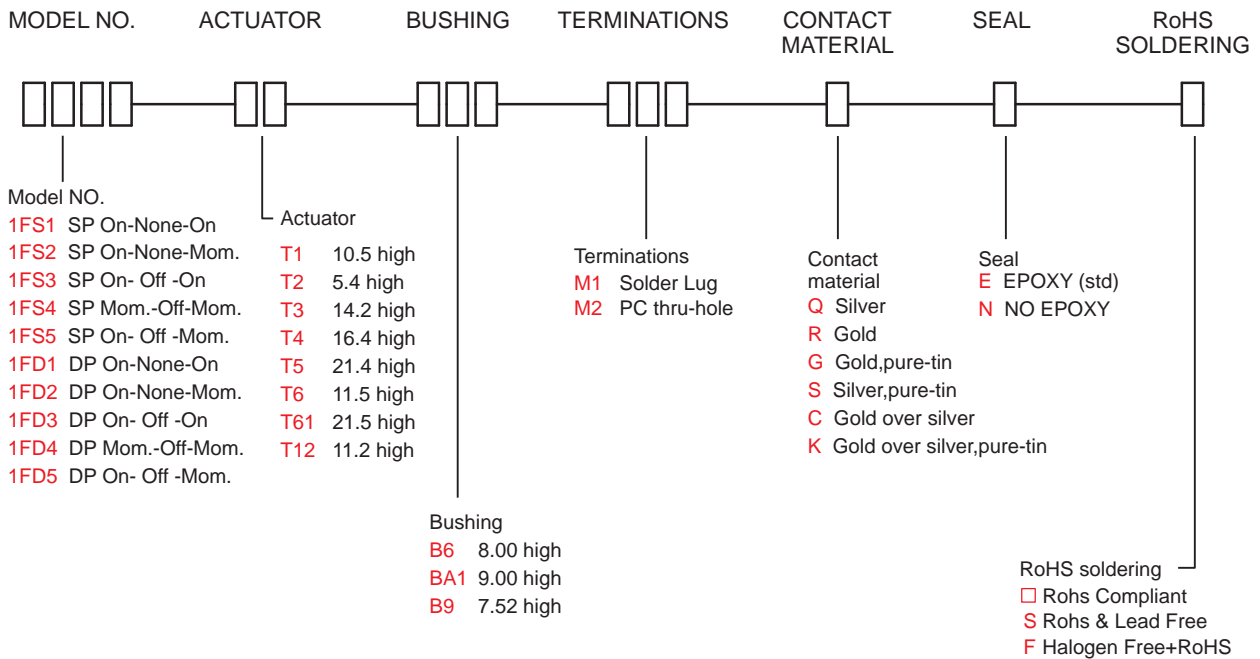

## HOW TO ORDER

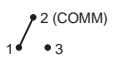

## SWITCH FUNCTION

| NO. POLES | MODEL NO. | SWITCH FUNCTION |       |       | CONNECTED TERMINALS / SCHEMATIC   |   |         |
|-----------|-----------|-----------------|-------|-------|---|---|---------|
|           |           | POS.1           | POS.2 | POS.3 | POS.1   | POS.2   | POS.3   |
| SP        | 1FS1      | ON              | NONE  | ON    | 2-3   | N/A   | 2-1     |
|           | 1FS2      | ON              | NONE  | MOM   |   |   |         |
|           | 1FS3      | ON              | OFF   | ON    |  |  |         |
|           | 1FS4      | MOM             | OFF   | MOM   |   |   |         |
|           | 1FS5      | ON              | OFF   | MOM   |   |   |         |
| DP        | 1FD1      | ON              | NONE  | ON    | 2-3,5-6   | N/A   | 2-1,5-4 |
|           | 1FD2      | ON              | NONE  | MOM   |   |   |         |
|           | 1FD3      | ON              | OFF   | ON    |  |  |         |
|           | 1FD4      | MOM             | OFF   | MOM   |   |   |         |
|           | 1FD5      | ON              | OFF   | MOM   |   |   |         |

MOM=MOMENTARY

## ACTUATOR OPTIONS

T1 STD

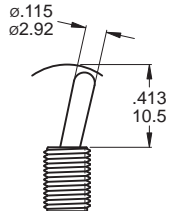

T2

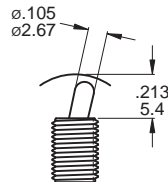

T3

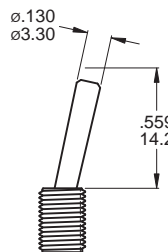

T4

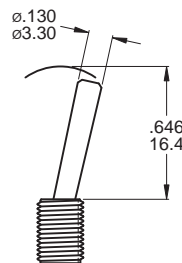

T5

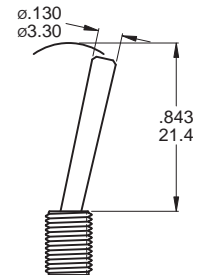

T6 FLATTED WITH ANTIROTATION

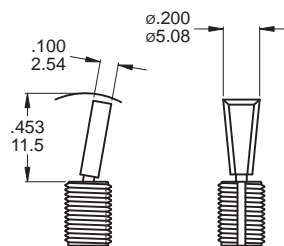

T61

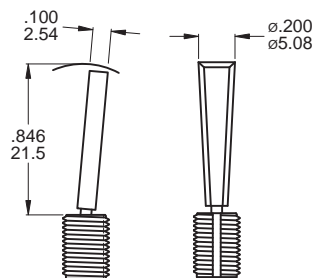

T6,T6-1 use with B6 bushing only

T12

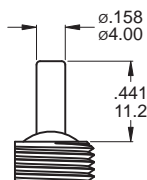

T12 use with BA1 bushing only

\*T12 actuator mechanical life 200,000 cycles

## TERMINATION OPTIONS

M1 Solder lug

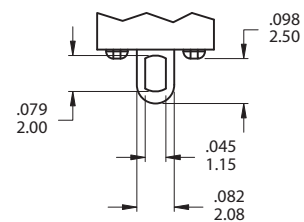

M2 PC Thru - hole

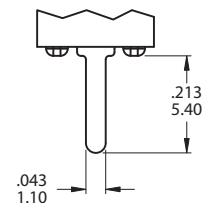

1F  
Toggle Switches

## BUSHING OPTIONS

### B6 HIGH TORQUE

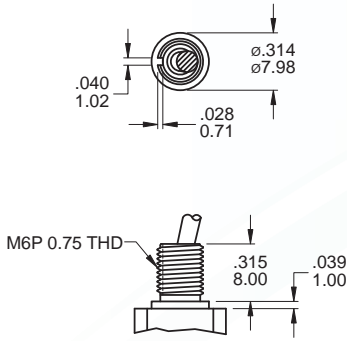

### B9 SPLASH PROOF

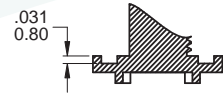
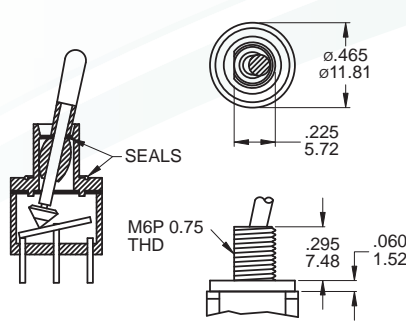

### CP-1TEB

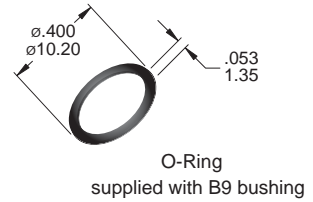

### BA1 SPLASH PROOF

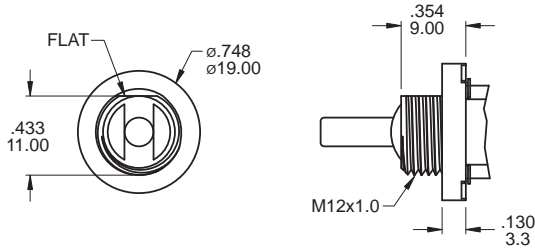

Use with T12 actuators only  
BA1 Bear Strength from top of actuator  
up to 10kg aside up to 15kg

## POLE OPTIONS

### SPDT

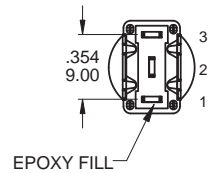
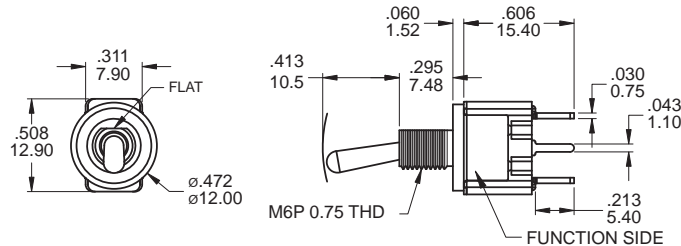

Part No. Shown : 1FS1T1B9M2RES

### DPDT

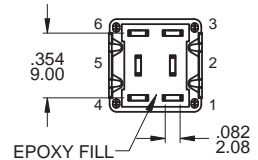
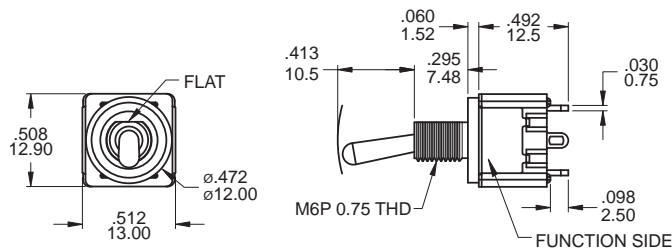

Part No. Shown : 1FD1T1B9M1QES

## SPDT

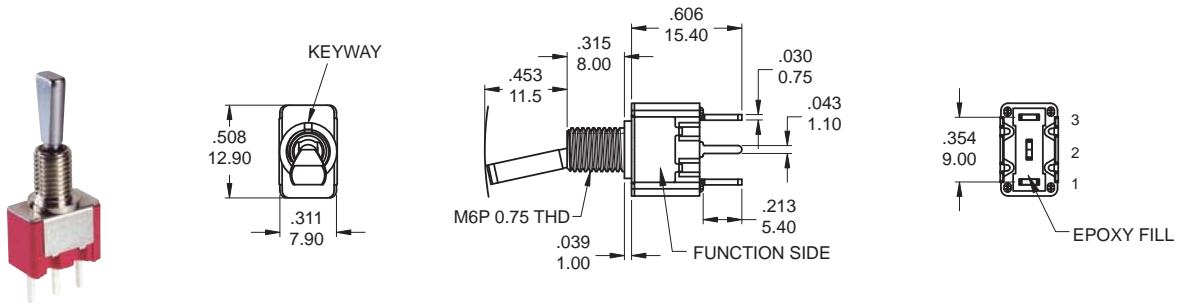

Part No. Shown : 1FS1T6B6M2QES

## DPDT

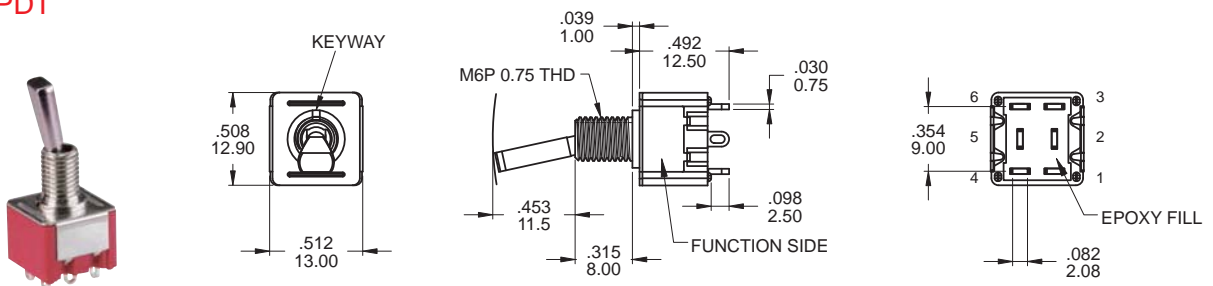

Part No. Shown : 1FD1T6B6M1QES

## SPDT

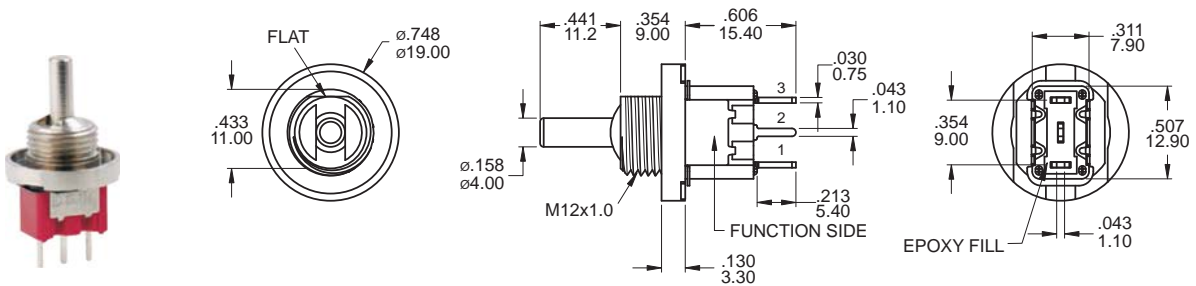

Part No. Shown : 1FS1T12BA1M2QES

## DPDT

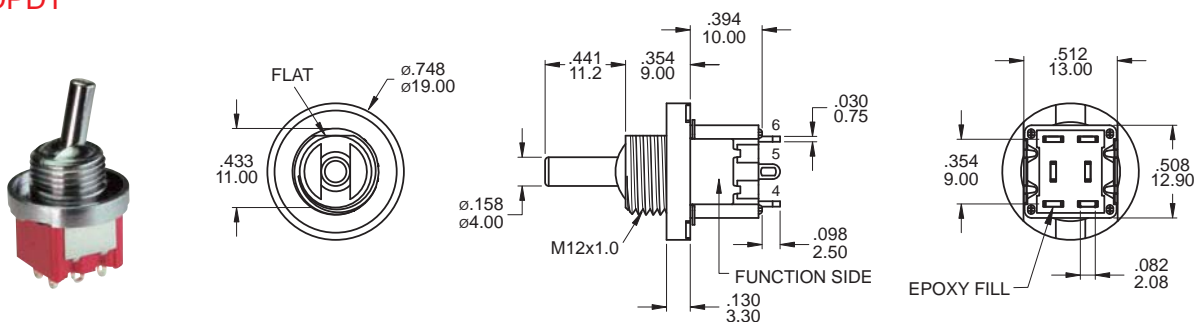

Part No. Shown : 1FD1T12BA1M1QES

## CONTACT MATERIAL OPTIONS

|          | CONTACT PLATING  | TERMINAL PLATING                       | RATINGS   |
|----------|------------------|--|---|
| <b>Q</b> | Silver           | <b>Q</b> = Silver                      | 6 Amps with resistant load @ 125VAC or 28VDC<br>3 Amps with resistant load @ 250VAC |
| <b>S</b> |                  | <b>S</b> = Silver,pure - tin           |   |
| <b>C</b> | Gold over Silver | <b>C</b> = Gold over silver            |   |
| <b>K</b> |                  | <b>K</b> = Gold over silver,pure - tin |   |
| <b>R</b> | Gold             | <b>R</b> = Gold                        | 0.4 Volt - Amps ( VA ) max. @ 20V max. ( AC or DC )                                 |
| <b>G</b> |                  | <b>G</b> = Gold,pure - tin             |   |

## SOLDERING PROCESSES

**MANUAL SOLDERING** : Use soldering iron of 30 watts, controlled at 350°C  
approximately 5 seconds while applying solder.

**WAVE SOLDERING**: Recommended Soldering Temperature: 260 ± 5°C

Duration of Solder Immersion: Max 5 sec. (PCB is 1.6mm in thickness)

